

Plat of Survey

of

Part of Lot 13 in Block 2 and a parcel of land located in Blocks 2 and 4 of Carswells Park,

a subdivision located in the Northeast 1/4 of Section 35, Town 4 North, Range 16 East, Town of LaGrange, Walworth County, Wisconsin.

More particularly described as follows:

A parcel of land described in a Warranty Deed recorded July 26, 2001 as Document No. 478047 as shown below:

Beginning at the NW corner of Lot 13, Block 2, Carswells Park at the shore of Middle Lake, thence S. 17° E. 51 feet to the North line of a highway, thence N. 85° 56' 30" E. along the North line of said highway 50 feet more or less to the E. line of Lot 13, thence N. 16° W. 57.5 feet to the shore of Middle Lake, thence Westerly along the shore line 50 feet more or less to the place of beginning. Also beginning at the NW corner of Lot 19, Block 3, of said Subdivision, thence N. 5° 00' W. on the prolongation of the W. line of said Lot 19, 19.8 feet to a point, thence N. 85° 57' W. 143.2 feet, thence N. 2° 37' W. 351.7 feet to a point, thence S. 88° 48' E. 82.5 feet to the place of beginning, thence continue S. 88° 48' E. 83.2 feet to a point, thence S. 10° 58' E. 120.0 feet, thence N. 88° 48' W. 50.0 feet, thence N. 10° 58' W. 22.9 feet, thence S. 88° 54' W. 48.3 feet to a point, thence Northerly 100 feet more or less to the place of beginning.

Surveyed for: **Keefe Real Estate, Inc.**
1040 North Wisconsin Street
Elkhorn, Wisconsin. 53121

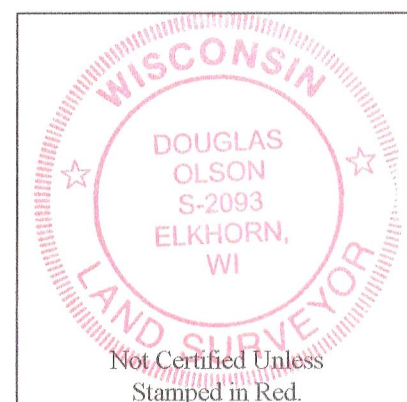

Notes:

- 1) This survey plat is not certified unless signed and sealed in red ink.
- 2) This survey is subject to Wisconsin lien laws. This Plat of Survey is the notice of intent to file lien. Lien waiver required.

Copyright 2011 by Jensen & Olson Land Surveying, LLC.

All rights reserved. No part of this survey plat may be reproduced or transmitted in any form by any means - graphic, electronic, or mechanical, including photocopying, tracing, or information storage and retrieval systems - without permission in writing from Douglas G. Olson, Jensen & Olson Land Surveying, LLC.

I hereby certify that I have surveyed the above described property and the map hereon is correct to the best of my professional knowledge and belief and shows the size and location of the property, its exterior boundaries, the location and dimensions of all visible structures thereon, boundary fences, apparent easements and roadways and visible encroachments, if any.

This survey is made for the exclusive use of the present owners of the property, and also those who purchase, mortgage or guarantee title thereto, within one year from the date hereof.

Douglas G. Olson
Wisconsin Registered Land Surveyor - 2093

Middle

Lake

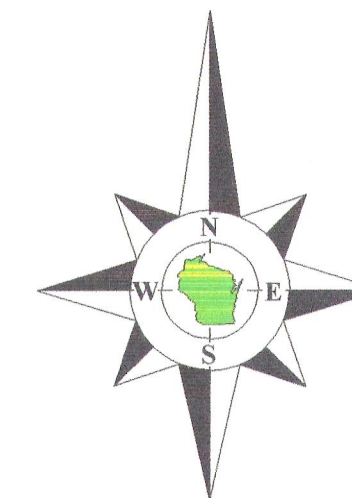

Bearings referenced to previous surveys.

Survey Date: November 16, 2011.
Revisions:

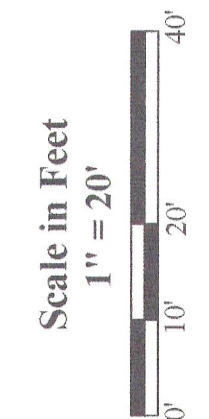

Jensen & Olson Land Surveying, LLC
45 South Wisconsin Street * P.O. Box 322 * Elkhorn, Wisconsin. 53121
Telephone: (262) 723-3434 * Facsimile: (262) 723-8044
Email: jensen.olson@elknet.net

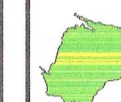

Legend
Found Iron Pipe
Found Iron Rod
Recorded Information
Utility Pole
Utility Pedestal
Concrete Cover
Asphalt Surface
Gravel Surface
Stone

Sheet 1 of 1 Sheets
Drawing Name: 444r16c-201116-201116Plat.sjg
Job Reference Number
2011.116

2011.116

HCA-56A3

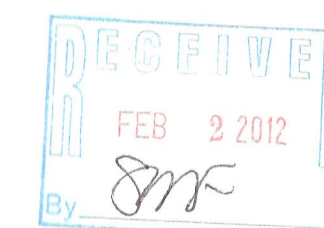

416-2578